

# Alta

TRAVEL TRAILER SERIES



*Alta*  
TRAVEL TRAILER SERIES



[EastToWestRV.com/Alta](http://EastToWestRV.com/Alta)  
A DIVISION OF FOREST RIVER





3150 KBH

#### TT - DOUBLE AXLE STANDARD FEATURES

- ▶ 81" Interior Height
- ▶ 2" Sidewalls with Azdel on Both Sides
- ▶ 5" Vacuum-bonded roof
- ▶ 15k BTU Ducted AC
- ▶ Heated and Enclosed Underbelly
- ▶ 35k BTU Furnace
- ▶ Universal Docking Station with Drop Frame Construction
- ▶ High Output On-Demand Hot Water Heater
- ▶ Automotive Painted Front Cap
- ▶ 200 Watt Roof Mounted Solar Panel with 30 Amp Controller
- ▶ Power Awning
- ▶ Aluminum Rims
- ▶ Goodyear® Tires (Mandatory)
- ▶ Individually Controlled Power Stabilizer Jacks
- ▶ Power Tongue Jack
- ▶ Slam Latch Baggage Doors



3150 KBH Outside Kitchen



Solid Entry Step with Tool Box



Universal Docking Station



Shower Port



Large Drop Frame Pass Through Storage



1600 MRB-LE



Murphy Bed "Up"



Murphy Bed "Down"  
60" x 80"



2810 KIK

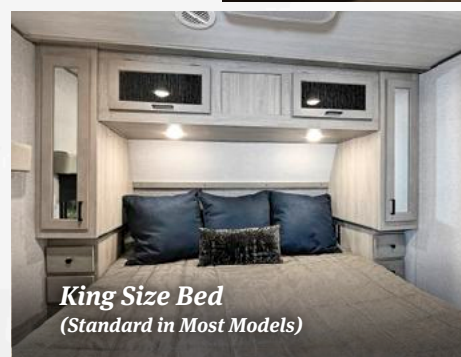

King Size Bed  
(Standard in Most Models)

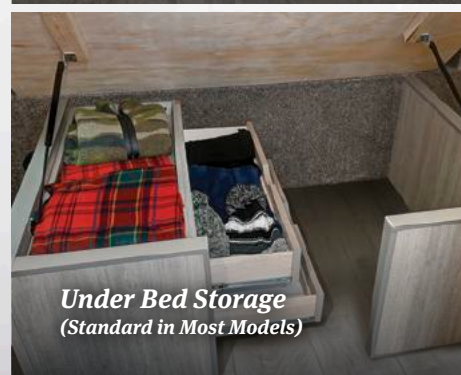

Under Bed Storage  
(Standard in Most Models)



30 x 36 Residential Inspired Shower  
(Standard in Most Models)



1600 MRB-LE

#### LE - SINGLE AXLE STANDARD FEATURES

- ▶ Full 8' wide
- ▶ 81" Interior Height
- ▶ 1.5" Sidewalls with Azdel on Both Sides
- ▶ 5" Vacuum-bonded roof
- ▶ 15k BTU Ducted AC
- ▶ Heated and Enclosed Underbelly
- ▶ Universal Docking Station
- ▶ High Output On-Demand Hot Water Heater
- ▶ 19k BTU Furnace
- ▶ 200 Watt Roof Mounted Solar Panel with 30 Amp Controller
- ▶ Aluminum Rims
- ▶ Goodyear® Tires (Mandatory)
- ▶ Power Awning



1600 MRB-LE



2400 KTH



King Size Bed

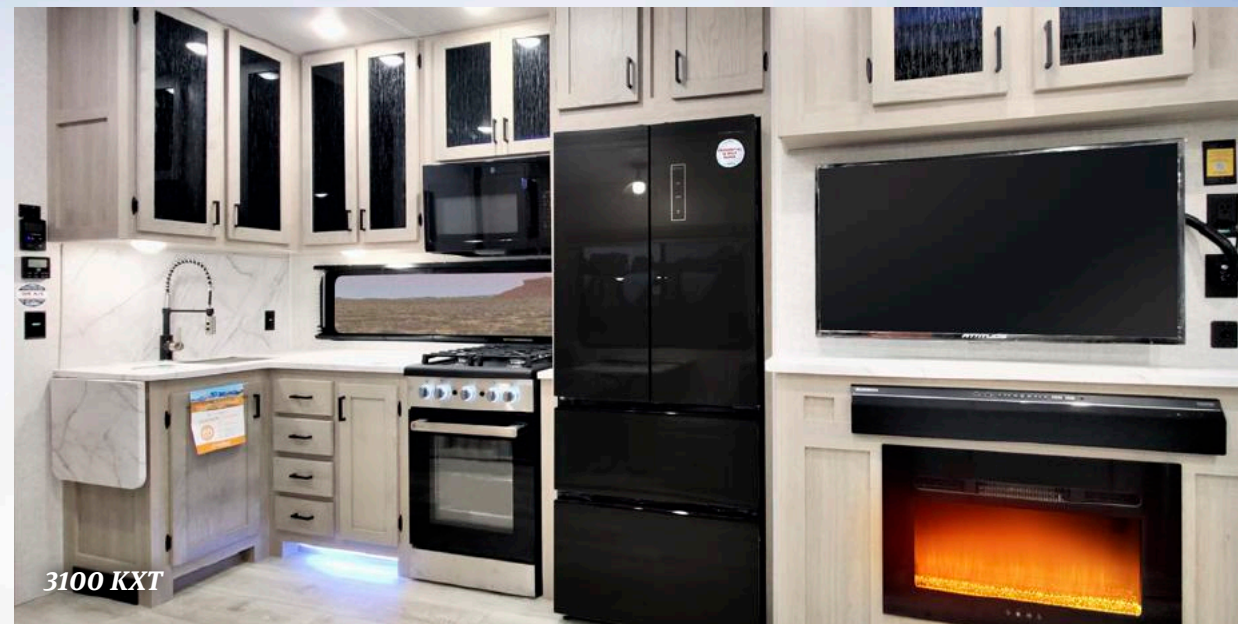

3100 KXT



3100 KXT



2870 KTH

#### KTH TOYHAULER STANDARD FEATURES

- ▶ 50 Amp Service (Mandatory)
- ▶ 2nd 15k AC (Mandatory)
- ▶ 3/4" Marine Grade Composite Flooring
- ▶ 30 Gallon Fuel Station
- ▶ Side & Rear Power Awning with LED Lights
- ▶ Full Magnetic Rail Kit
- ▶ 3 Seasons Door with Adjustable Glass Panels
- ▶ Happijac® Bunk System
- ▶ 101" Wide Body Construction
- ▶ 96" Ceiling Height Throughout
- ▶ Generator-Ready
- ▶ 400 Watt Solar Power with 2 Batteries and a 30 Amp Controller
- ▶ Aluminum Rims
- ▶ Goodyear® Tires (Mandatory)
- ▶ Power Tongue Jack
- ▶ Individually Controlled Power Stabilizer Jacks



2870 KTH



Office Area



Stowable Bunk System



3100 KXT



3100 KXT



King Size Bed with Best in Class Storage

#### XTREME 365 STANDARD FEATURES

- ▶ 50 Amp Service (Mandatory)
- ▶ Two 15k ACs with Heat Pumps
- ▶ 101" Wide Body Construction
- ▶ 5" Vacuum-Bonded Roof
- ▶ 3" Laminated Walls with Azdel on Both Sides
- ▶ 96" Interior Ceiling Height Throughout
- ▶ Dual Pane Windows
- ▶ Double-Insulated Floors with a ThermoFoil Barrier
- ▶ Forced Air Heated Underbelly with Additional Tank and Water line Heaters
- ▶ Aluminum Rims
- ▶ Goodyear® Tires (Mandatory)
- ▶ Power Awning
- ▶ Individually Controlled Power Stabilizer Jacks
- ▶ Power Tongue Jack
- ▶ Slam Latch Baggage Doors
- ▶ Washer / Dryer Prep
- ▶ Oversized 40k BTU Furnace
- ▶ 5k BTU Electric Fireplace
- ▶ 400 Watt Solar Power with 2 Batteries and a 30 Amp Controller
- ▶ Heated Pass-through Storage
- ▶ 16.2 Cu. Ft. 12v Residential-Inspired Refrigerator
- ▶ 24" Residential-Inspired Free-Standing Range

# Alta

## TRAVEL TRAILER SERIES

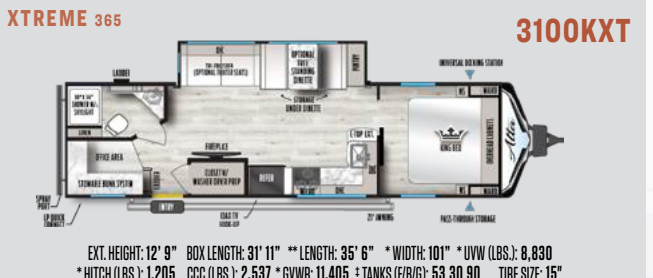
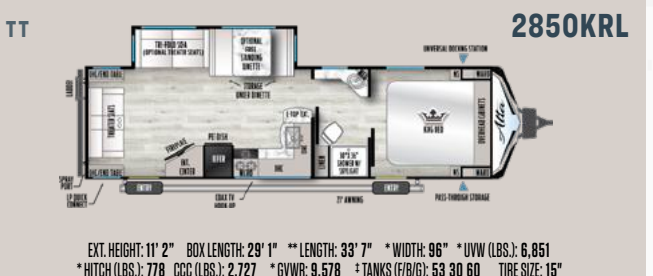
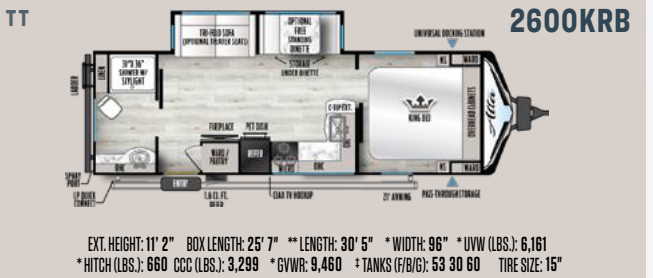
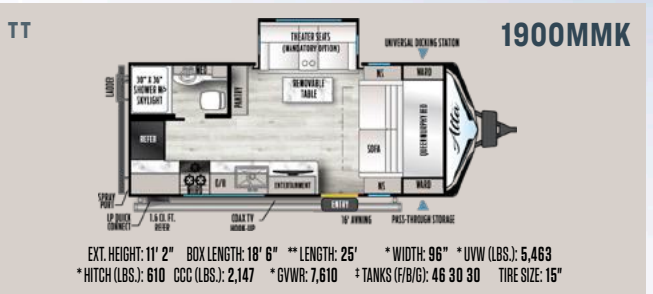
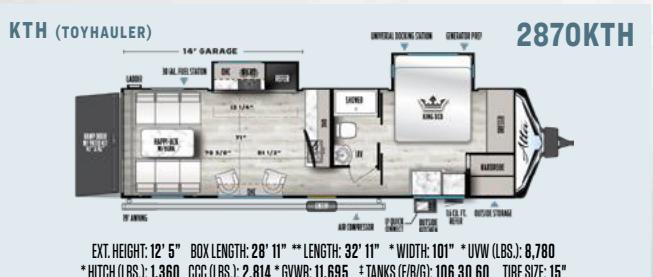
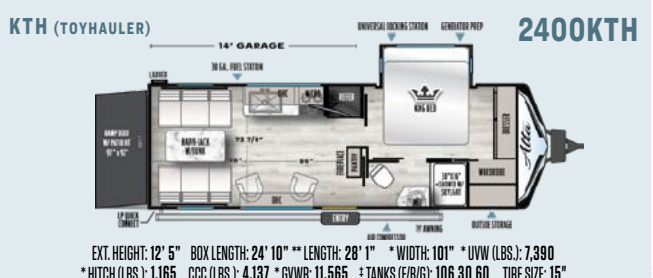
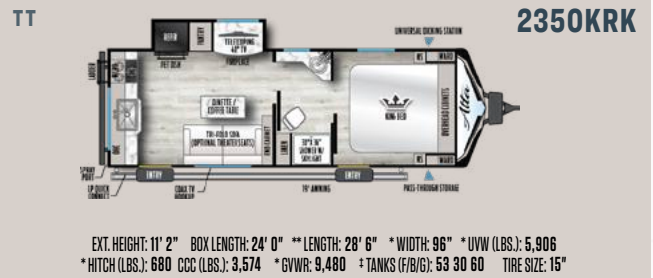
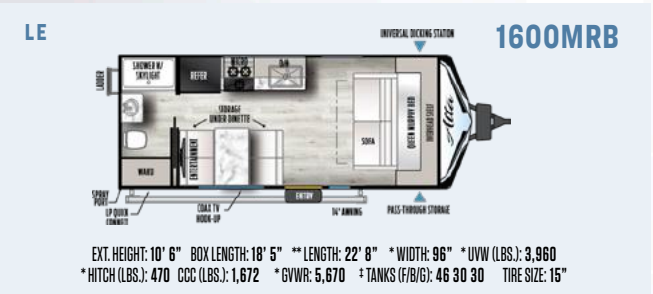
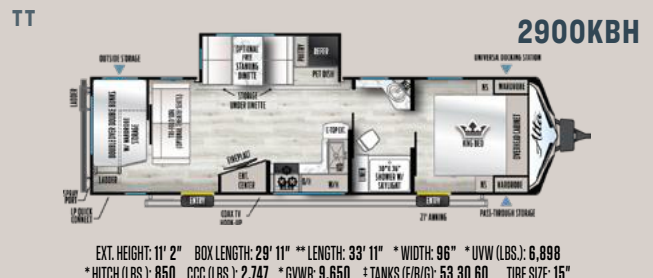
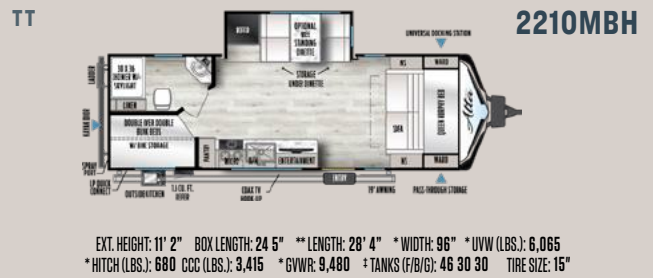

## ALTA STANDARD PACKAGES & OPTIONS

### LUXE DÉCOR PACKAGE (MANDATORY)

81" Interior Ceiling Height	•	•	--	--
96" Interior Ceiling Height	--	--	•	•
10.7 Cubic Foot 12 Volt Black Glass Residential-Inspired Refrigerator	•	•	•	--
3-Burner Range w/ Oven	•	--	•	•
Xtreme Appliance Package -19.2 Cubic Foot Double Door 12 Volt Refer w/ Free-standing Range (Xtreme 365 only)	--	--	--	•
Solid Bedroom Door Where Available	•	--	•	•
Cable/Satellite Ready	•	•	•	•
USB Charging Stations (Beds, Bunks, & Tables Where Available)	•	•	•	•
Sink Cover	•	•	•	•
Tri-fold "Ez-Out" Sleeper Sofa Where Available	•	--	•	•
Designer Solid Surface Countertops	•	•	•	•
Skylight Above Shower	•	•	•	--
4k Interior LED Lights	•	•	•	•
ABS Tub Surround & Cabinet In Bath	•	•	•	•
Where Available	•	•	•	•
Oversized Window Package with Valance and Lambrequin Window Treatments	•	•	•	•
Black Roller Shades	•	•	•	•
Dual Pane Windows (Xtreme 365 only)	--	--	--	•
Porcelain Foot Flush Toilet	•	--	•	•
Storage Drawers Underneath Where Available	•	--	•	•
Upgraded Residential-Inspired Linoleum Flooring	•	•	•	•
19,000 BTU Furnace (LE only)	--	•	--	--
35,000 BTU Furnace (TT, KTH only)	•	--	•	--
40,000 BTU Furnace (Xtreme 365 only)	--	--	--	•
2 Zone Sound System Bluetooth / HDMI Connectivity	•	•	•	•
Pet Drawer Where Available	•	--	--	--
Under Bed Storage Where Available	•	--	--	•

TT (Travel Trailer) LE (Single Axle) KTH (Toy Hauler) KXT (Xtreme 365)

### ADVANTAGE PACKAGE (MANDATORY)

5" Vacuum Bonded Roof	•	•	•	•
96" Laminated Sidewalls with Azdel on both Sides	--	--	--	•
2" Laminated Sidewalls with Azdel on both Sides (1 1/2" on LE)	•	--	•	--
Aluminum Rims	•	•	•	•
Universal Docking Station	•	•	•	•
Water Heater Bypass	•	•	•	•
Power Awning with LED Lights & Auto Dump	•	•	•	•
Enclosed & Heated Underbelly	•	•	•	•
Flush Floor Slide Out Where Available	•	--	--	•
15,000 BTU Ducted Air Conditioner with Quick Cool	•	•	•	•
15,000 BTU Ducted Air Conditioner with Heat Pumps (Xtreme 365 only)	--	--	--	•
Tank & Water Line Heaters (Xtreme 365 only)	--	--	--	•
Black Tank Flush	•	•	•	•
Outside Shower with Hot & Cold Water	•	•	•	•
High Output On-Demand Tankless Water Heater	•	•	•	•
High Definition/Amplified TV Antenna with Wi-Fi Prep	•	•	•	•
Backup Camera Prep	•	•	•	•
Rear Ladder	•	•	•	•
Diamond Plate Front Rock Guard	•	•	•	•
Exterior LED Lights	•	•	•	•
Detachable Power Cord	•	•	•	•
Power Tongue Jack with LED Light	•	--	•	•
2nd Power Awning Control in the Pass Through Storage Compartment	•	•	--	•
Exterior Swing Arm Entry Assist Handle	•	•	•	•
4-Point Individually Controlled Power Stabilizer Jacks	•	--	•	•
Marine Grade Exterior Speakers	•	•	•	•

Aluminum Rims	•	•	•	•
Upper Bunk Window	•	•	•	•
R.V.Q. Quick Connect	•	•	•	•
High Pressure Fresh Water Fill	•	•	•	•

### OPTIONS

Goodyear® Tires (Mandatory on all models)	•	•	•	•
Solid Entry Step (Mandatory all Models)	•	•	•	•
Theater Seating IPO Tri-fold Sofa Where Available	•	--	--	•
60" x 80" Queen Bed	•	--	•	•
32" LED Smart TV	•	•	--	--
40" LED Smart TV (N/A 1600MRB-LE, 1900MMK, 2210MBH)	•	--	•	--
50" LED Smart TV	--	--	--	•
50 Amp Service with 2nd A/C Prep: (Mandatory on 2600KRB 2800KBH, 2810KIK, 2850KRL, 2900KBH, 3150KBH)	•	--	--	--
50 Amp Service with 2nd 15,000 BTU A/C Installed (Mandatory on 2400KTH, 2870KTH, 3100KXT, 3250KXT)	--	--	•	•
Free-standing Dinette IPO Booth (N/A 1600MRB-LE, 1900MMK, 2350KRW, 2400KTH, 2870KTH)	•	--	--	•
Alta Solar Package - 200 Watt Panel, 30 Amp Controller, Battery, Box, and Disconnect. (Mandatory on TT & LE)	•	•	--	--
West Coast Power Package - 200 Watt Panel, 30 Amp Controller and Second Battery (Mandatory on KTH & KXT)	•	•	•	•

- R34", 1" x 3" Aluminum double welded floor joist, 16" on center on TT (R38 on Xtreme 365) (R34 one piece composite floor on KTH)
- Thermofoil insulation with glued and screwed 5/8" tongue & groove plywood floor (KTH 3/4" one piece composite floor)
- R10", 2" Aluminum double welded sidewalls on TT & KTH (R7", 1 1/2" on LE) (R15" on Xtreme 365)
- Laminated sidewalls with Azdel® on board both inside and out
- R21", Aluminum trussed vacuum-bonded roof
- Alpha Ply® roof with Limited Lifetime Warranty
- Automotive painted fiberglass front cap with diamond plate rock guard & LED marker lights (N/A on LE)
- Heavy duty slam-latch baggage with doors and finished pass thru storage
- 4- Power stabilizer jacks with individual controls (N/A on LE)
- Electric power tongue jack with LED light (N/A on LE)
- Twin 20 LB LP bottles with auto switch over & easy access cover (Single 20 LB on LE) (Dual 30 LB on Xtreme 365)
- 15,000 BTU ducted A/C (With added heat pumps on Xtreme 365)
- Aluminum wheels with Goodyear® tires
- Drop frame (N/A on LE, KTH)
- Tinted safety glass windows (Dual pane on Xtreme 365)
- Enclosed and forced-air heated underbelly (Tank and water line heaters Xtreme 365)
- One piece linoleum flooring throughout
- High density block foam insulation in the laminated walls & roof
- Aluminum framed sidewalls, roof, slide box, and radius front cage
- 35k BTU furnace on TT & KTH (40k BTU on Xtreme 365) (19k BTU on LE)

\*EQUIVALENT THERMAL RESISTANCE, CALCULATED R-VALUE



**OUR COMPANY TAKES PRIDE IN OUR FIVE GUIDING PRINCIPLES AND OUR CORPORATE PHILOSOPHY**  
which focuses on people working together to create high quality, value-added products that deliver the ultimate RV experience.

### Sustainable Manufacturing

An important objective to our strategy and operations is to implement economically sound manufacturing processes to reduce/recycle waste & conserve energy and natural resources.

### Corporate & Social Responsibility

We foster a business environment in which we focus on and practice:

- Ethical Labor Practices
- Teamwork
- Philanthropy
- Volunteering

### Culture & Values

We are a forward thinking company committed to fostering a culture of teamwork. By being transparent, we encourage our employees to think outside the box and make a difference!

### Quality & Construction

Our team takes pride in each unit we build. Our manufacturing standards and point to point inspections ensure each EAST TO WEST brand is built to the same quality specifications every time.

### Our Commitment

We strive to provide the highest quality products at the best possible price to our customers. We invite you to be a part of the EAST TO WEST family and we look forward to exceeding your expectations!



### 24/7 EMERGENCY ROADSIDE ASSISTANCE WITH VEHICLE PURCHASE\*

TOWING  
JUMP-STARTS  
TIRE CHANGES  
FLUID DELIVERY  
LOCKOUT  
SERVICE

WINCH-OUT  
MOBILE MECHANIC  
TECHNICAL  
SUPPORT  
DEALER LOCATOR  
SERVICES



\*VALID FOR 1 YEAR FROM DATE OF PURCHASE



**Learn More**  
Scan this barcode using a QR Reader on your smart phone to learn more about Forest River.



A Berkshire Hathaway company.

3000 COUNTY ROAD 6 WEST ELKHART, IN 46514  
WWW.EASTTOWESTRV.COM/ALTA 574.264.6664

**FREE MEMBERSHIP**  
to Forest River Owners' Group

www.forestriverfrog.com



East To West RV



@easttowestr

### CUSTOMER SATISFACTION



www.ForestRiverBuyLocal.com



### PRE-DELIVERY INSPECTION FACILITY

20,000 square feet of quality assurance. The bare essentials for a premium product. This state-of-the-art facility gives immediate daily feedback to production for quality assurance in every unit built.

### SPECIFICATION DEFINITIONS

**GVWR (Gross Vehicle Weight Rating)** - is the maximum permissible weight of the unit when fully loaded. It includes all weights, inclusive of all fluids, cargo, optional equipment and accessories. For safety and product performance do NOT exceed the GVWR.

**GAWR (Gross Axle Weight Rating)** - is the maximum permissible weight, including cargo, fluids, optional equipment and accessories that can be safely supported by a combination of all axles.

**UVW (Unloaded Vehicle Weight)\*** - is the typical weight of the unit as manufactured at the factory. It includes all weight at the unit's axle(s) and tongue or pin and LP Gas. The UVW does not include cargo, fresh potable water, additional optional equipment or dealer installed accessories.

\*Estimated average based on standard build optional equipment.

**CCC (Cargo Carrying Capacity)\*\*** - is the amount of weight available for fresh potable water, cargo, additional optional equipment and accessories. CCC is equal to GVWR minus UVW. Available CCC should accommodate fresh potable water (8.3 lbs per gallon). Before filling the fresh water tank, empty the black and gray tanks to provide for more cargo capacity.

\*\* Estimated average based on standard build optional equipment

Each Forest River RV is weighed at the manufacturing facility prior to shipping. A label identifying the unloaded vehicle weight of the actual unit and the cargo carrying capacity is applied to every Forest River RV prior to leaving our facilities.

The load capacity of your unit is designated by weight, not by volume, so you cannot necessarily use all available space when loading your unit.

YOUR *Alta* DEALER

All information contained in this brochure is believed to be accurate at the time of publication. However, during the model year, it may be necessary to make revisions and Forest River, Inc., reserves the right to make all such changes without notice, including prices, colors, materials, equipment and specifications as well as the addition of new models and the discontinuance of models shown in this brochure. Therefore, please consult with your Forest River dealer and confirm the existence of any materials, design or specifications that are material to your purchase decision.  
Litho. U.S.A. FOR 2305 P&W: 2023.09.20